

Oil pumps

GPLII/GPMII

TERAL

50Hz

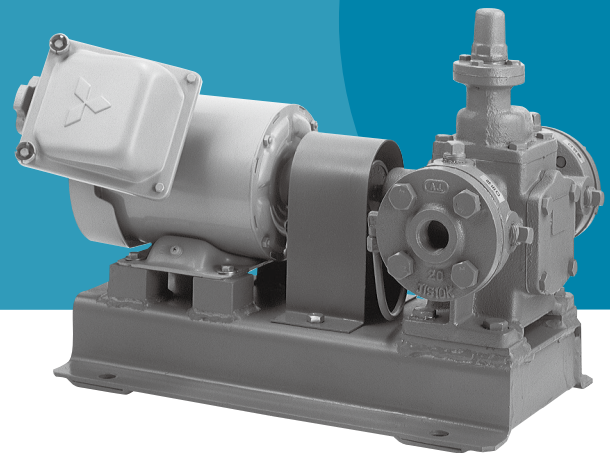

TERAL INC.

Applications

- For industry and for transfer of kerosene used in various facilities (buildings, housings, etc.)
- For transfer of various fuel oils
- For lubrication of various machines
- For transfer of various viscous solutions

Features

- ① As the gear is a one-point continuous contact and segmental gear, no liquid is trapped and neither high pressure nor high vacuum is generated, resulting in no noise or vibration.
- ② The bearing requires no lubrication because of a two-point support structure of a needle bearing and an internal plain bearing and forced self-lubrication.
- ③ As a mechanical seal is used for the shaft seal part, no liquid leak or air suction occurs.
- ④ As the pump has a built-in safety valve, abnormal pressure does not rise.

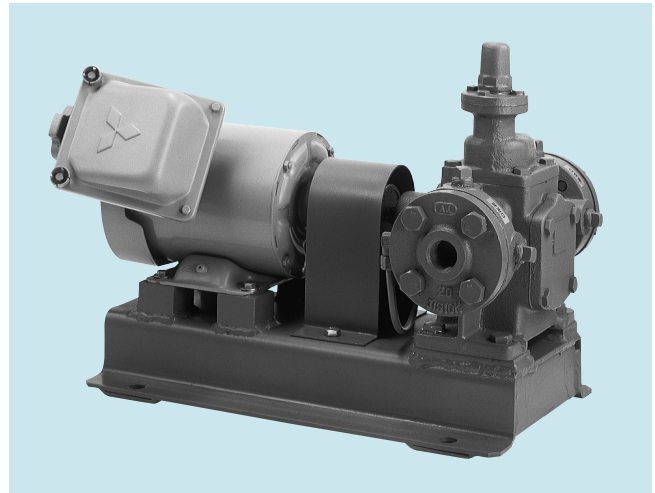

* Please note that the paint color, etc. of the actual unit may partially differ from the photo.

Description of types

②
GPLII - 25 V
① ③ ④

- ① Model
- ② Head type L: Low head M: High head
- ③ Nominal suction/discharge diameter (25mm)
- ④ Internal code

Standard specifications

Pumping liquid	Liquid quality	kerosene, light oil, heavy oil A
	Viscosity	Viscous liquid (1 - 300mm ² /s)
	Liquid temperature	0 - 80°C
Total suction head (In case of 20°C)		-5m
Allowable push-in pressure		0.10MPa
Structure	Impeller	Gear
	Shaft seal	Mechanical seal
	Bearing	Needle bearing
Material	Impeller	S45C
	Motor shaft	S45C
	Casing	FC200
Motor	Efficiency	Standard efficiency (equivalent to IE1)
	Starting method	Direct-on-Line start
	Type	Increased-safety explosion-proof indoor type
	Power source	3-phase 200V
	Synchronous rotation speed	1500min ⁻¹
Connection		Screwed type: 10 - 15mm Flange type, JIS 10K standard type: 20 - 50mm

*If the pumping liquid is heavy oil B, C and others, please contact us.

Standard accessories

Motor1
Common base1
Safety valve1
Companion flange (20mm or more)2 sets
Coupling1 set
Coupling cover1

Special specifications

Motor	Type	Totally enclosed fan-cooled type, explosion-proof type
	Power supply	Voltage change: single-phase / 100V, 3-phase / 400V

Special accessories

Sluice valve, Check valve, Pressure gauge, Compound gauge Strainer (Y type, single, duplex)
--

Specification table

● GPLII

Bore diameter mm	Type	Output kW	Specifications	
			Discharge pressure: MPa	Discharge rate L/min
10 (3/8)	GPLII-10V	0.2	0.3	16
15 (1/2)	GPLII-15V	0.2	0.3	16
20 (3/4)	GPLII-20V	0.4	0.3	29
25 (1)	GPLII-25V	0.75	0.3	46
32 (1 1/4)	GPLII-32V	1.5	0.3	67
40 (1 1/2)	GPLII-40V	2.2	0.3	105
50 (2)	GPLII-50V	3.7	0.3	155

Note) This specifications table shows the values when kerosene is used as a sample liquid.

● GPMII

Bore diameter mm	Type	Output kW	Specifications	
			Discharge pressure: MPa	Discharge rate L/min
10 (3/8)	GPMII-10V	0.4	0.4 - 0.5	14
15 (1/2)	GPMII-15V	0.4	0.4 - 0.5	14
20 (3/4)	GPMII-20V	0.75	0.4 - 0.5	26
25 (1)	GPMII-25V	1.5	0.4 - 0.5	42
32 (1 1/4)	GPMII-32V	2.2	0.4 - 0.5	63
40 (1 1/2)	GPMII-40V	3.7	0.4 - 0.5	100
50 (2)	GPMII-50V	5.5	0.4 - 0.5	150

Note) This specifications table shows the values when kerosene is used as a sample liquid.

Assembly drawing

● Bore diameter 10 - 15mm

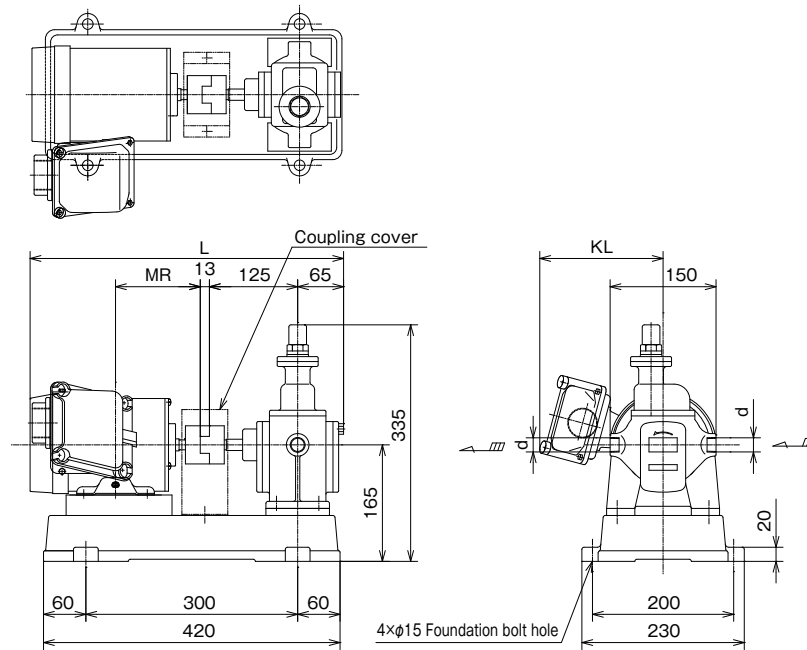

Dimensions

(Unit: mm)

Bore diameter d	Type	Output kW	L	KL	MR	Approx. mass kg
Rc ³ / ₈	GPLII-10V	0.2	415	165	103	29
Rc ³ / ₈	GPMII-10V	0.4	444	175	120	31
Rc ¹ / ₂	GPLII-15V	0.2	415	165	103	29
Rc ¹ / ₂	GPMII-15V	0.4	444	175	120	31

Note) Total length dimension, approximate mass and terminal box position may be slightly different depending on motor manufacturer.

Assembly drawing

● Bore diameter 20 - 25mm

Flange dimensions: JIS 10K standard type or equivalent

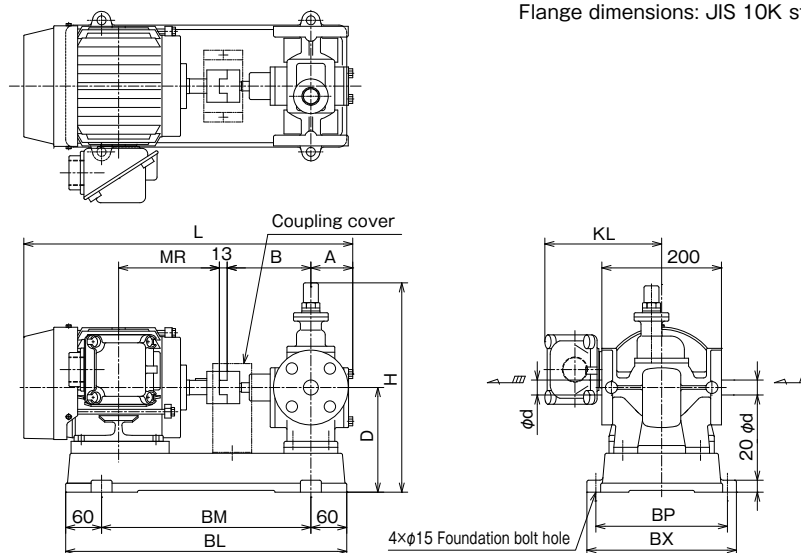

Dimensions

(Unit: mm)

Bore diameter d	Type	Output kW	A	B	D	H	L	KL	MR	BL	BM	BP	BX	Approx. mass kg
20	GPLII-20V	0.4	65	125	165	335	444	175	120	420	300	200	230	33
	GPMII-20V	0.75	65	125	165	335	476	181	140	420	300	200	230	40
25	GPLII-25V	0.75	70	140	175	350	496	181	140	470	350	220	250	44
	GPMII-25V	1.5	70	140	175	350	550	195	169	470	350	220	250	52

Note) Total length dimension, approximate mass and terminal box position may be slightly different depending on motor manufacturer.

Assembly drawing

● Bore diameter 32mm

Flange dimensions: JIS 10K standard type or equivalent

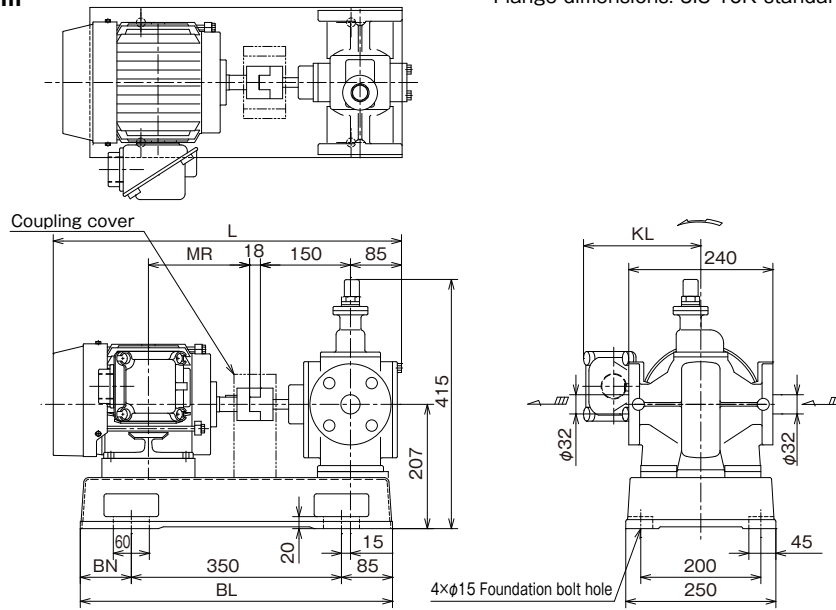

Dimensions

(Unit: mm)

Type	Output kW	L	KL	MR	BL	BN	Approx. mass kg
GPLII-32V	1.5	580	195	169	520	85	59
GPMII-32V	2.2	619	210	193	535	100	66

Note) Total length dimension, approximate mass and terminal box position may be slightly different depending on motor manufacturer.

Assembly drawing

● Bore diameter 40 - 50mm

Flange dimensions: JIS 10K standard type or equivalent

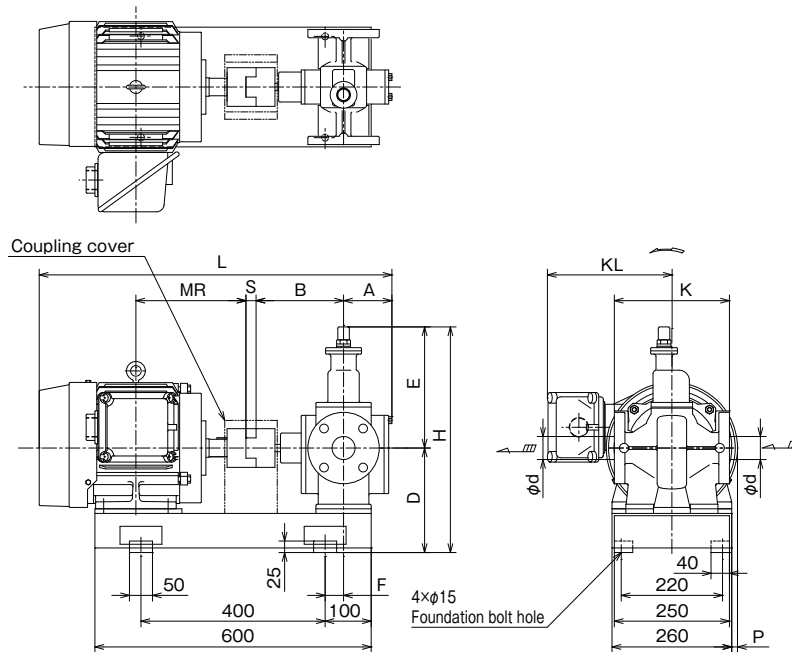

Dimensions

(Unit: mm)

Bore diameter d	Type	Output kW	A	B	D	E	F	H	K	L	P	S	KL	MR	Approx. mass kg
40	GPLII-40V	2.2	85	160	207	218	35	425	240	629	—	18	210	193	78
	GPMII-40V	3.7	85	160	207	218	35	425	240	646	—	18	227	200	92
50	GPLII-50V	3.7	105	190	227	263	30	490	250	700	—	22	227	200	102
	GPMII-50V	5.5	105	190	227	263	40	490	250	766	12.5	22	271	239	124

Note) Total length dimension, approximate mass and terminal box position may be slightly different depending on motor manufacturer.

Example of sectional drawing

●Bore diameter 10 - 15mm

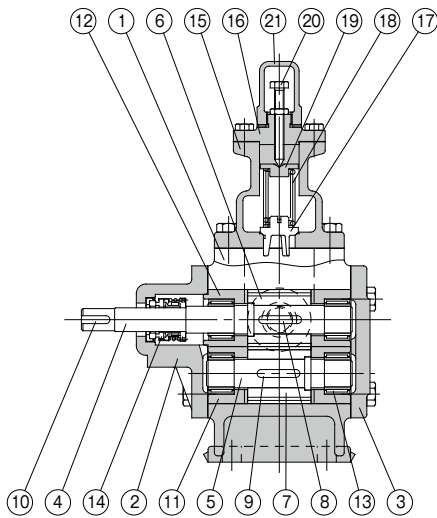

●Bore diameter 20 - 25mm

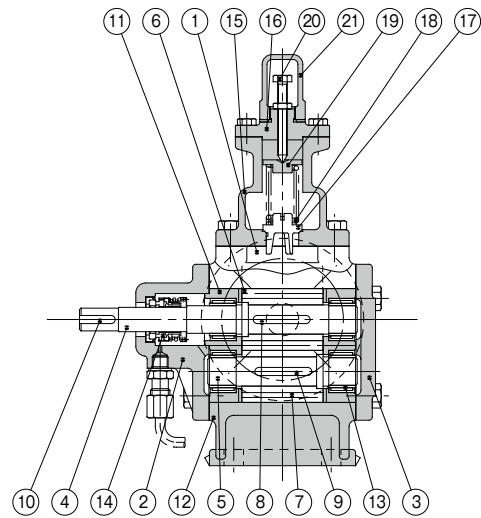

Parts list

No.	Part name	Qty	Material
1	Casing	1	FC200
2	Gland case	1	FC200
3	Side cover	1	FC200
4	Main drive shaft	1	S45C
5	Driven shaft	1	S45C
6	Main drive gear	1	S45C
7	Driven gear	1	S45C
8	Key	1	S50C
9	Key	1	S50C
10	Key	1	S50C
11	Housing	3	FC200

No.	Part name	Qty	Material
12	Housing	1	FC200
13	Needle bearing	4	SUJ2
14	Mechanical seal	1	Ceramic vs Carbon
15	Relief valve body	1	FC200
16	Relief valve cover	1	FC200
17	Relief valve	1	CAC403
18	Relief valve spring	1	SWPA
19	Spring retainer	1	SS400
20	Adjusting screw	1	SS400
21	Cap	1	FC200

MEMO

A series of horizontal dashed lines providing a template for writing a memo.



TERAL INC.

Head Office 230, Moriwake, Miyuki-cyo, Fukuyama-city, Hiroshima, 720-0003, Japan
Tel.+81-84-955-1111 Fax.+81-84-955-5777
www.teral.net

Teral Asia Limited

Room 1001,10/F, Olympia Plaza, 255 King's Road, North Point, Hong Kong
Tel.+852-2571-0935 Fax.+852-2571-0619

TERAL THAI CO.,LTD.

150 Moo 16 Udomsoraryuth Rd., T.Bangkrasan, A.Bangpa-In, Ayutthaya 13160 Thailand
Tel.+66-3535-2148-9 Fax.+66-3535-2150

TERAL TRADING & SERVICE CO.,LTD.

150 Moo 16 Udomsoraryuth Rd., T.Bangkrasan, A.Bangpa-In, Ayutthaya 13160 Thailand
Tel.+66-3535-2145-7 Fax.+66-3535-8549

Teral Malaysia Sdn.Bhd.

10, Jalan SS13/6A, Subang Jaya Industrial Estate, 47500, Subang Jaya, Selangor D.E, Malaysia
Tel.+60-3-5611 5775 Fax.+60-3-5612 5775

PT.Teral Indonesia Pumps and Fans

Jalan BSD Sektor XI Taman Tekno, Block G3 No.8, Setu Tangerang Selatan, Banten, Indonesia 15314
Tel.+62-21-29665778 Fax.+62-21-75673913

Teral Vietnam Limited Liability Company

Room 1306, 13th Floor, BIDV Tower, 194 Tran Quang Khai Street, Ly Thai To Ward, Hoan Kiem District, Hanoi, Vietnam
Tel.+84-24-3935-2790 Fax.+84-24-3935-2800

Teral General Machine (Shanghai) Co.,Ltd.

No.285, Yuan Qu Road(N), Bei Qiao, Min Hang District, Shanghai 201109, China
Tel.+86-21-6490-9128 Fax.+86-21-6490-9126

Teral-Aerotech Fans Private Ltd.

Plot No.188-189, Ecotech Extension-1, Surajpur Kasna Road, Greater Noida-201306, Uttar Pradesh, India
Tel.+91-9810162210, +91-9310162210

Teral Middle East F.Z.C.

1806-002, 18th floor, BB1, Mazaya Business Avenue, JLT, Dubai, UAE. PO Box 414781
Tel.+971-4369 9039

Teral Pumps & Fans North America Ltd.

Suite # 197, 800-15355 24 Ave Surrey, B.C., CANADA V4A 2H9
Tel.+1-604-839-1008